

# TAIBAO SIANGHE

## 太保祥和漫遊



## Chiayi Taibao 嘉義縣太保祥和街區

Taibao City, originally named "Gouwei Village," was the birthplace of Wang De-lu, a distinguished general of the Qing Dynasty noted for recruiting forces to assist the Qing government in quelling the Lin Shuang-wen rebellion in Taiwan. He was given the title of "Tai Tze Tai Bao" (prince of Taibao) after his passing. To honor his legacy, the people of Gouwei renamed the town "Taibao."

A number of historic buildings are preserved in the area, including Wang De-lu's official residence, and the Wang family temple, north to the family residence. The memorial tablets of Wang De-lu and other ancestral members are enshrined in the family temple, which was later renovated by the Wang family. A handful of curios, including relics the general used, and imperial decrees given to Wang, are kept in the temple. Taibao City is now home to the Southern Branch of the National Palace Museum, the seat of Chiayi County Government, and one of the ten stations served by the Taiwan High Speed Rail.

太保是清領時期傳奇人物王得祿將軍的故鄉。當年他因為協助清政府平定林爽文事件，逝世後受封太子太保的官銜。鄉民為了紀念他，便將原來的地名「溝尾」改為「太保」。境內也因此保留了不少相關的歷史建築，包括王得祿的提督府衙以及府衙北側的王氏家廟；府衙裡保有部分的古物，而後人重建的家廟內，則供奉王得祿與歷代祖先的靈位，還有他生前的文物、皇室聖旨等，供後人敬仰參觀。如今的太保市是國立故宮博物院南部院區、嘉義縣政府的所在地，且為高鐵的十站之一。



### How to get there? 交通資訊

#### Transportation 自行開車

Take Nat'l Hwy 1 → Provincial Highway 82 to get off at Exit No. 14 → Chiayi County Hwy 45 → Get off Taibao 1st Rd.  
國道1號 - 臺82線14號出口下交流道 - 嘉45鄉道 - 太保一路

#### Public 大眾運輸

Take THSR to Chiayi Station → BRT shuttle 7211 (toward Puzi) → Get off at Chiayi County Government Station  
搭高鐵至高鐵嘉義站 - 轉搭 BRT公車7211線(往朴子方向) - 至嘉義縣政府站下

Take THSR to Chiayi Train Station → Transfer to shuttle bus 7209 → Get off at Anren Borough Station  
搭臺鐵至嘉義火車站 - 轉搭公車7209線 - 至安仁里站下



英語友善店家  
English-friendly shop



主辦單位



承辦單位



廣告

### No. 888, Gugong Blvd., Taibao City, Chiayi County 嘉義縣太保市故宮大道888號

The Southern Branch of the National Palace Museum (NPMSB) is located in Taibao City, Chiayi County near THSR Chiayi Station. Other than the museum building, a manmade lake occupies the center of the NPMSB compound. A garden bridge crossing the southern part of the lake leads to the museum's reception hall on the second floor. The museum building's two streamlined structures are evocative of the cultural symbols of dragon, elephant and horse. In continuation of the building's dynamic style, the scenic bridge resembles a Chinese cursive script. The bridge's passageway seems to be encouraging visitors to enter the museum at a leisurely stroll.

故宮南院位於嘉義縣太保市，鄰近高鐵嘉義站，除了博物館主體，院區中央另設有人工湖，並有一景觀橋橫跨南端人工湖，可將參觀遊客接引至博物館二樓大廳。其建築造型由兩個流線型主體交織而成，作為「龍」、「象」、「馬」文化象徵的隱喻。為呼應主體建築的造型，銜接建築量體動勢，景觀橋的結構形式與造型採用書法中草書的形式，以富韻律的動態氣勢引導入館人群接近主體建築，並提供參覽遊客最獨特與舒適的步行經驗。

### No.1, Gongchangtsun, Suantoutangchang, Liujiao Township, Chiayi County 嘉義縣六腳鄉工廠村1號

Suantou Sugar Refinery was established in 1903 and shut down due to the air raids of the Allied Forces in World War II. In June 2002, the factory was designated as a historical site. Renovations thus began to turn the compound into the "Jhecheng Cultural Park" that integrated recreational, cultural, and historical education functions. The heritage assets from the Japanese Colonial Period remain in the park, including as the bomb shelter used in World War II, old trees, historical site of the Shinto shrine, an ancient posthouse, a Japanese-style dormitory, an octagonal structure, the "half-width" railway used for conveying sugarcane. Having been reconstructed, the railway can transport the visitors back in time to explore the rise and decline of the past sugar industry.

蒜頭糖廠蔗埕文化園區，於日治時代明治三十六年建廠，經歷第二次世界大戰盟軍轟炸被迫停工。民國九十一年六月製糖工廠走入歷史，並於原址規劃成休閒、文化、思古的「蔗埕文化園區」。園區有日治時期所遺留資產，如二次世界大戰的防空洞、珍貴老樹、神社遺址、古早驛頭、日式宿舍、八角樓建築及早期運送甘蔗的五分車鐵道，藉著改造可運送遊客穿越時空隧道，了解早期糖業的興衰。

### No. 21-25, Gexiliao, Shuishang Township, Chiayi County 嘉義縣水上鄉鵝溪寮21-25號

The Solar Exploration Center in Shueishang Township, Chiayi County, is the largest city landmark among those 16 countries where the Tropic of Cancer passes through. Taiwan is also the biggest island on the Tropic of Cancer. The 6th generation Solar Exploration Center is styled like a space shuttle. There are five levels in the building. On Floor 1 is the Astronomy Education Center; the Astronomy Classrooms are located on Floors 2, 3, and 4; and on Floor 5 is the Solar Theme Exhibition Hall. Elevated belvederes and areas are also installed for visitors to take in the view in distance, and to enjoy the scenic landscape of the Center. No entrance fee is charged.

北回歸線太陽館位於嘉義縣水上鄉，為北迴歸線穿過的16個國家中最大的城市地標，台灣同時也是北迴歸線上最大的島嶼。北回歸線第六代地標的太陽館，外型建築特徵有如太空梭，內部則為天文主題館。配置方面目前共有五個樓層，一樓為天文教育中心；二、三、四樓規劃為天文教室；五樓則是太陽主題展覽館，並規劃觀景台與遠眺區，可讓民眾欣賞整個園區的景色。對外開放，且不收取門票費用。

國立故宮博物院南部院區  
National Palace Museum

蒜頭糖廠蔗埕文化園區  
Jhecheng Cultural Park

北回歸線太陽館  
The Solar Exploration Center

### 01 Tri-fooding Tea & Snacks 三食而粒

- 05-3627279
- Business hours : 08:30~17:30  
營業時間：08:30~17:30
- No.133, Taibao 2nd Rd., Taibao City, Chiayi County  
嘉義縣太保市太保二路133號
- Honey Tangerine Black Tea  
茂谷柑紅茶
- Dragon Fruit Beauty Tea  
火紅美人茶
- Lemon Green Tea  
香檸綠茶
- Dried Orange and Lemon Tea Blend  
柑檸檬乾沖泡組
- Red Date and Goji Berry Tea  
紅棗枸杞茶



### 03 Yu Ding Tian Du Seaweed Bar 御鼎田都

- 05-3623328
- Weekday : 09:30~20:00 / Weekend:09:30~19:30(Closed on Sunday)  
平日：09:30~20:00 / 假日：09:30~19:30 (週日公休)
- No. 92, Sec. E., Xianghe 1st Rd., Taibao City, Chiayi County  
嘉義縣太保市祥和一路東段92號
- Meat gimhap  
海苔飯卷 (葷食)
- Vegetarian gimhap  
海苔飯卷 (素食)
- Japanese Rice Bowl with Seaweed  
海苔蓋飯
- Seaweed Bento Box  
海苔便當
- Black Tea  
紅茶



### 02 GloriFried Chicken FlagshipStore 佳佳香專業炸雞

- 05-3628189
- Business hours : 14:30~22:30  
營業時間：14:30~22:30
- No. 17, Sec. E., Xianghe 1st Rd., Taibao City, Chiayi County  
嘉義縣太保市祥和一路東段17號
- Sweet Potato with Plum Powder  
甘梅地瓜
- Boneless Popcorn Chicken  
無骨鹽酥雞
- Fried Chicken Triquetrum  
三角骨
- Calamari Squid  
魷魚
- Crispy Breaded Chicken Cutlet  
香酥雞排



### 04 Magic Tea 魔力手作茶

- 05-3625566
- Business hours : 08:30~23:00  
營業時間：08:30~23:00
- No. 216, Sec. E., Xianghe 3rd Rd., Taibao City, Chiayi County  
嘉義縣太保市祥和三路東段216號
- Frozen Lemonade with Honey  
蜜檸檬飲
- Fresh Passion Fruit Green Tea with Tapioca Pearls  
鮮百香QQ綠
- Fresh Adzuki Bean Milk with Tapioca Pearls  
紅豆Q奶
- Fresh Milk with Brown Sugar and Tapioca Pearls  
黑糖鮮奶珍珠
- Lemonade with Winter Melon  
冬瓜檸檬



**05 Wonderful Good Food**  
香味真粥道

☎ 05-3620303  
🕒 Business hours : 07:30~19:30 (Closed on Saturday)  
營業時間：07:30~19:30 (週六公休)

📍 No.8, Sec. W., Jiapu Rd., Puzi City, Chiayi County  
嘉義縣朴子市嘉朴路西段 8 號

🍲 Boneless Milkfish Congee  
無刺虱目魚肚粥

🌿 Vegetarian Assorted Noodle Soup  
素食什錦湯麵

🍲 Boneless Sea Bass Congee  
無刺鱸魚粥

🍲 Congee with Pork and Century Egg  
皮蛋瘦肉粥

🍲 Whitebait Congee  
吻仔魚粥

🇮🇩 Bahasa Indonesia



**06 Maserati Fresh Meals**  
瑪·莎菀·帝

☎ 05-3621898/0983-303555  
🕒 Business hours : 10:00~12:30 (Closed on Saturday and Sunday)  
營業時間：10:00~12:30 (週六、週日公休)

📍 No. 18, Wenchang St., Taibao City, Chiayi County  
嘉義縣太保市文昌街18號

🍲 Salad Box(The box contains pork/beef, but it can include plant foods for flexitarians)  
生菜沙拉盒 (含豬肉/牛肉 · 可做鍋邊素)

🍲 Health Nuts Meal Box(The box contains pork/beef)  
養生餐盒 (含豬肉/牛肉/魚肉)

🍲 Vegetarian Meal Box  
蔬食餐盒

🍲 Kettle Meal Box(The box contains pork/fish)  
水煮餐盒(含豬肉/魚肉)

🍲 -Low-fat, Lean, Low-Sodium, Freshly-made-  
-少油 · 低脂 · 低鈉 · 鮮做-



**09 Nonstop Delicacy**  
炒味亭

☎ 05-3622163  
🕒 Weekday : 10:30~13:30/17:00~20:00  
Weekend : 10:30~14:00/17:00~20:00 (Closed on Sunday)  
平日：10:30~13:30/17:00~20:00  
假日：10:30~14:00/17:00~20:00 (週日公休)

📍 No.17, Sec. E., Xianghe 3rd Rd., Taibao City, Chiayi County  
嘉義縣太保市祥和三路東段 17 號

🍲 Beef Fried Rice  
牛肉炒飯

🍲 Assorted Fried Rice  
什錦炒飯

🍲 Beef Fried Noodles  
牛肉炒麵

🍲 Assorted Fried Noodles  
什錦炒麵

🍲 Fried Egg Noodles  
炒意麵



**10 Sanma Stinky Hot Pot**  
三媽臭臭鍋

☎ 05-3625119  
🕒 Business hours : 11:00~23:15  
營業時間：11:00~23:15

📍 No.13, Sec. E., Xianghe 1st Rd., Taibao City, Chiayi County  
嘉義縣太保市祥和一路東段 13 號

🍲 Stinky Hot Pot with Pork Intestines  
大腸臭臭鍋

🍲 Seafood and Tofu Hot Pot  
海鮮豆腐鍋

🍲 Kimchi Hot Pot  
泡菜鍋

🍲 Fish Head Hot Pot with Taiwanese BBQ Sauce  
沙茶魚頭鍋

🍲 Hot & Spicy Hot Pot  
麻辣鍋



**07 Sunny Fresh Juice**  
陽光鮮果汁之專賣店

☎ 0919509310  
🕒 Business hours : 10:30~22:00  
營業時間：10:30~22:00

📍 No.200, Sec. E., Xianghe 3rd Rd., Taibao City, Chiayi County  
嘉義縣太保市祥和三路東段 200 號

🍹 Mango Juice  
芒果汁

🍹 Lemonade  
檸檬汁

🍹 Signature Mixed Fruit Juice  
招牌綜合果汁

🍹 Sunny Mixed Fruit Juice  
陽光綜合果汁

🍹 Watermelon Smoothie  
西瓜冰沙



**08 Chef Bear**  
熊廚師

☎ 0952-309934  
🕒 Weekday : 11:30~14:00/17:00~22:00  
Weekend : 11:30~22:00 (Closed on Monday and Tuesday)  
平日：11:30~14:00/17:00~22:00  
假日：11:30~22:00 (週一、週二公休)

📍 No.10, Sec. E., Xianghe 1st Rd., Taibao City, Chiayi County  
嘉義縣太保市祥和一路東段 10 號

🍲 Spaghetti Bolognese  
波隆那肉醬義大利麵

🍲 Epic Meat Pie  
手工牛肉派

🍲 Banana Bread  
手工香蕉蛋糕

🍲 Spicy Garlic Chicken Pasta  
蒜辣雞肉義大利麵

🍲 Spaghetti Alle Vongole  
白酒蛤蜊義大利麵



**11 Ding's Famous Braised Pork on Rice**  
丁家魯肉飯

☎ 0912-754290  
🕒 Business hours : 10:00~21:00 (Closed on Tuesday)  
營業時間：10:00~21:00 (週二公休)

📍 No.82, Sec. E., Xianghe 1st Rd., Taibao City, Chiayi County  
嘉義縣太保市祥和一路東段 82 號

🍲 Braised Pork on Rice  
魯肉飯

🍲 Shiitake Thick Soup with Pork  
香菇肉羹湯



**12 True Boss (Chiayi County Government Branch)**  
醋頭家縣府店

☎ 05-3622330  
🕒 Weekday : 09:00~21:00/Weekend : 09:00~19:00  
平日：09:00~21:00/假日：09:00~19:00

📍 No.125, Sec. W., Xianghe 3rd Rd., Taibao City, Chiayi County  
嘉義縣朴子市祥和三路西段 125 號

🍹 Apple Cider Vinegar FruitSangria  
蘋果吃醋醋

🍹 Green Plum Vinegar Power Punch  
青梅吃醋醋

🍹 Nectarine Vinegar Sweet Lux  
蜜桃吃醋醋

🍹 Cranberry Vinegar Fruit Flow  
蔓越莓吃醋醋

🍹 Mango Vinegar Fruit Fantasy  
芒果醋醋

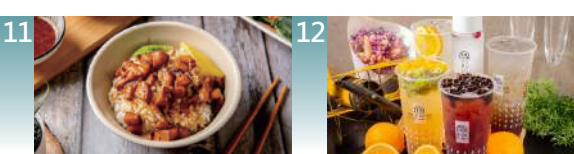
**13 Jaun Thai Restaurant**  
卷卷泰式廚房

☎ 05-3623370  
🕒 Business hours : 11:00~14:00 (Closed on Sunday)  
營業時間：11:00~14:00 (週日公休)

📍 No.25, Sec. E., Xianghe 3rd Rd., Taibao City, Chiayi County  
嘉義縣太保市祥和三路東段 25 號

🍲 Pork & Basil Stir-fry  
打拋豬肉飯

🍲 Thai Fried Rice  
泰式炒飯

🍲 Spicy Chicken with RiceStir-fry  
辣炒雞肉飯

🍲 Dry-fried Rice Noodles with Seafood  
海鮮乾炒河粉

🍲 Thai Seafood Hot & Sour Soup  
泰式海鮮酸辣湯



**14 Amo Tasty Cuisine**  
阿墨風尚料理

☎ 05-3625701  
🕒 Business hours : 11:00~21:30  
營業時間：11:00~21:30

📍 No.8, Bangqiu 1st St., Taibao City, Chiayi County  
嘉義縣太保市棒球一街 8 號

🍲 Singapore Laksa Seafood Pot  
新加坡叻沙海鮮煲

🍲 Thai-style Spiced Chicken Drumstick with Chili Sauce  
泰式酸辣椒麻雞

🍲 Japanese Teppanyaki Pork Chop  
日式和風豬排板燒

🍲 Fettuccine Alfredo with Smoked Chicken  
奶油燻雞義大利麵

🍲 Japanese Fruit Curry Chicken Leg Teppanyaki  
日式咖喱水果雞腿板燒



**17 Wei Bo Technology Trade Co., Ltd**  
威柏科技貿易有限公司

☎ 05-3209919  
🕒 Business hours : 09:00~18:00 (Closed on Weekend)  
營業時間：09:00~18:00 (週六、日公休)

📍 No.187, Jiankang Rd., Taibao City, Chiayi County  
嘉義縣太保市健康路 187 號

🍷 WiWU One Axis Anti-Shaking Selfie Stick  
WiWU 單軸雲台防手震穩定器

🍷 WiWU Hard Shell Smart Case for Headsets with Sleep Mode  
WiWU 智能休眠耳罩耳機收納包

🍷 WiWU PD+QC3.0 Fast Travel Charger Adapter with Dual Port  
WiWU 20W雙模PD+QC3.0快充電源供應器

🍷 WiWU Airbuds Wireless Bluetooth Earbuds with Light Sensor  
WiWU Airbuds 無線藍牙耳機Light Sensor真光感版

🍷 SYLPH Multipurpose, dual-usehandheld vacuum  
SYLPH 多功能兩用型攜帶式吸塵器



**15 Mei & Mei Breakfast Stop**  
美而美早餐

☎ 05-3628881  
🕒 Business hours : 05:30~13:00  
營業時間：05:30~13:00

📍 No.86, Sec. E., Xianghe 1st Rd., Taibao City, Chiayi County  
嘉義縣太保市祥和一路東段86號

🍷 Hamburgers & Toast  
漢堡&吐司

🍷 Taiwanese Omelet  
蛋餅



**16 Sodas and Spirits**  
稻香冰店

☎ 05-3621517  
🕒 Business hours : 09:00~20:30  
營業時間：09:00~20:30

📍 No. 37, Taibao 2nd Rd., Taibao City, Chiayi County  
嘉義縣太保市太保二路37號

🍷 Adzuki Bean Ice with Milk  
紅豆牛奶雪花冰

🍷 Freshly-squeezed Juice  
高纖果汁

🍷 Avocado Milkshake  
酪梨牛奶

🍷 Kiwi with Pineapple  
奇異果鳳梨

🍷 Tofu Pudding Medley  
綜合豆花



# Arts and Culture for Traveling Light

## 藝文知性 輕旅行

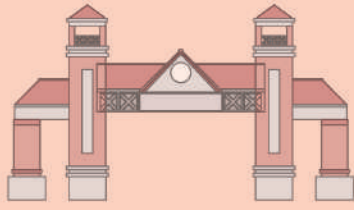

Suantou Sugar Refinery Jhecheng Cultural Park  
蒜頭糖廠蔗埕文化園區



08 Chef Bear  
熊廚師



16 Sodas and Spirits  
稻香冰店



01 Tri-fooding Tea & Snacks  
三食而粒



04 Magic Tea  
魔力手作茶

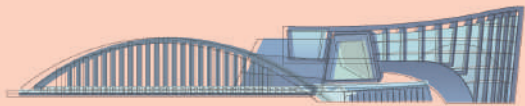

Southern Branch of the National Palace Museum  
國立故宮博物院南部院區



End of Tour 遊程結束

